

# Disassembly and cleaning instructions



for Positioning Shell NAV curved  
SAP/Art. No. 75000648/21000411

These disassembly and cleaning instructions are designed to supplement the existing brochure «Instructions for instrument preparation», Lit. No. 1363.

## Key

- 1 Impactor
- 2 Cardan insert
- 3 Swivel nut
- 4 Adapter sleeve

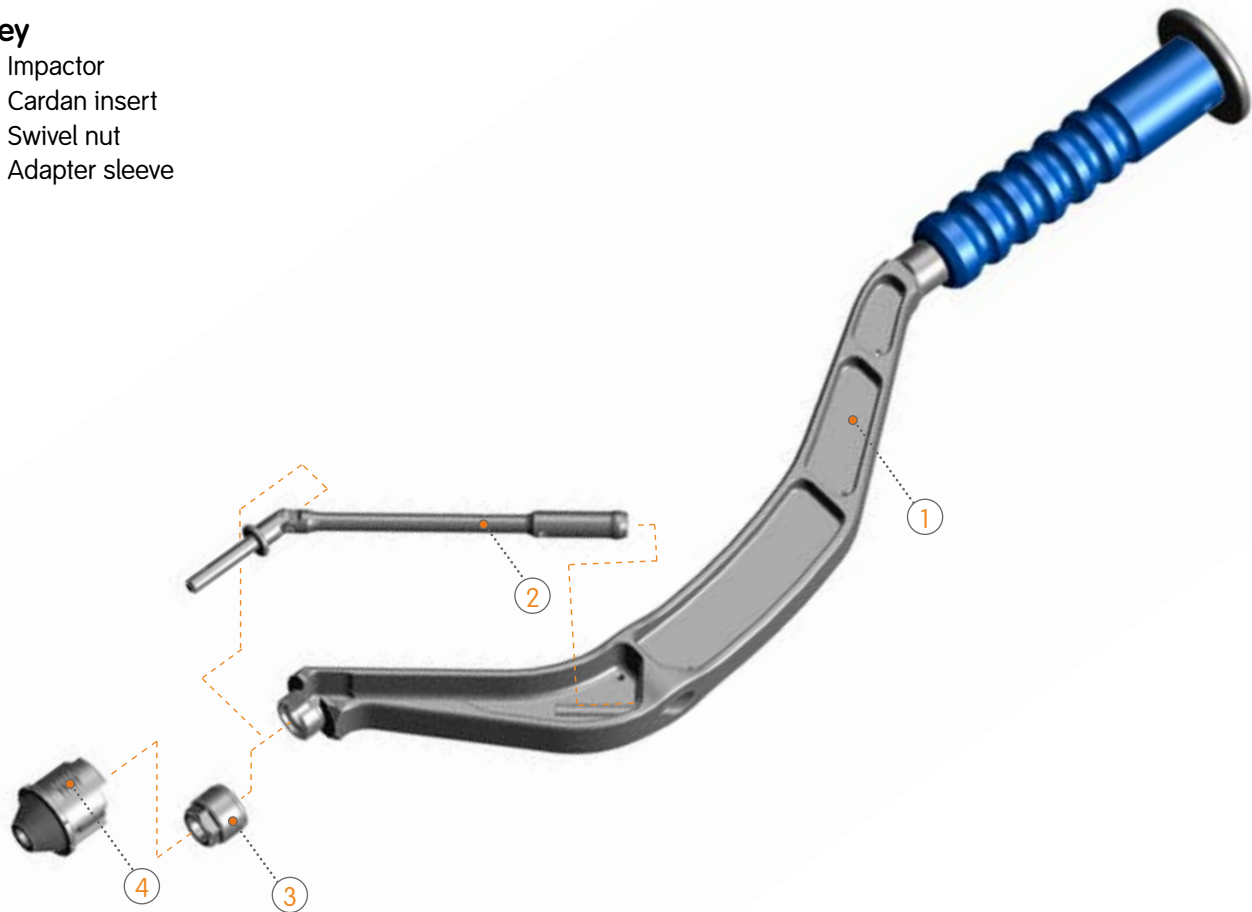

## Disassembly

In accordance with the instructions for instrument preparation Lit. No. 1363

The following applies in addition to or in place of the instructions:

- Remove the adapter sleeve (4) from the impactor (1)
- Loosen the swivel nut (3) with the screwdriver
- Pull the cardan insert (2) from the impactor (1)

## Pre-cleaning

In accordance with the instructions for instrument preparation Lit. No. 1363

The following applies in addition to or in place of the instructions:

- Manually pre-clean all drill holes, passages and threads

## Machine cleaning and disinfection

In accordance with the instructions for instrument preparation Lit. No. 1363

The following applies in addition to or in place of the instructions:

- Please take special care to ensure that any cavities can be properly rinsed

## Drying

In accordance with the instructions for instrument preparation Lit. No. 1363

The following applies in addition to or in place of the instructions:

- All drill holes and cavities can also be dried with pressurised air

## Checking and testing

In accordance with the instructions for instrument preparation Lit. No. 1363

The following applies in addition to or in place of the instructions:

- Check the thread for signs of damage

## Servicing

In accordance with the instructions for instrument preparation Lit. No. 1363

## Assembly

In accordance with the instructions for instrument preparation Lit. No. 1363

The following applies in addition to or in place of the instructions:

- Assembly is in reverse to disassembly
- The adapter sleeve (4) should be mounted so that the laser markings are in line with the markings on the impactor (1)

## Please note

1 Screwdriver 75000XXX/21000670

